

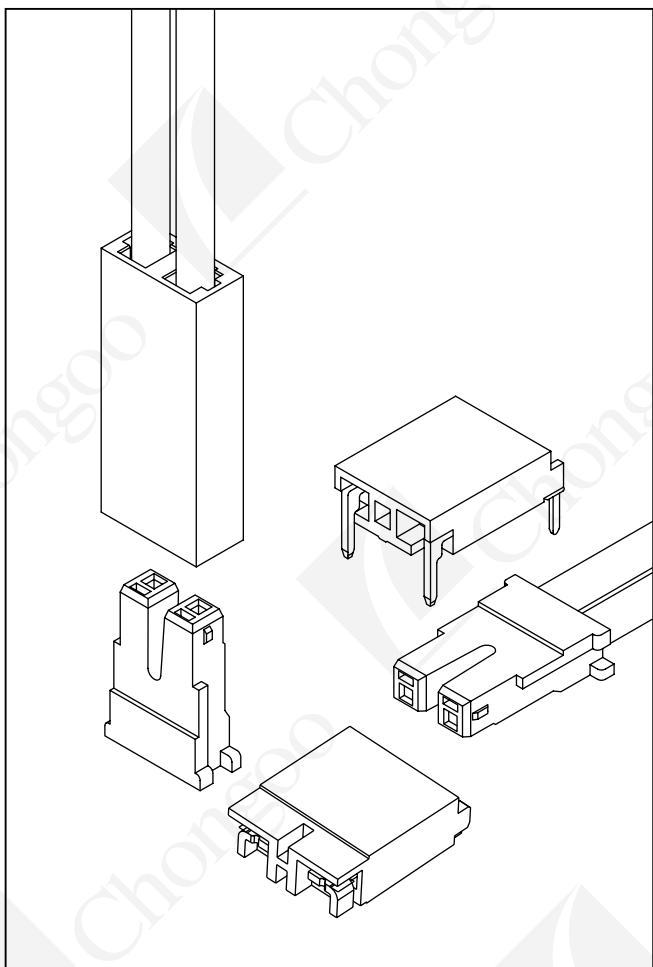

■ 技术参数 TECHNICAL PARAMETR

1. 间距 Pitch: 3.50mm
2. 额定电流 Current Rating: 1.0A AC/DC.
3. 额定电压 Voltage Rating: 1400V AC/DC.
4. 温度范围 Temperature range: -25°C~+85°C
5. 耐压 Withstand Voltage: 3800V/min
6. 接触电阻 Contact resistance: $\leq 10\text{m}\Omega$
7. 绝缘电阻 Insulation resistance: $\geq 1000\text{M}\Omega$
8. 适用电线 Applicable wire: AWG#30~#22
9. 适应基板厚度 Applicable PC board thickness: 1.60mm

■ 安装图 Assembly layout

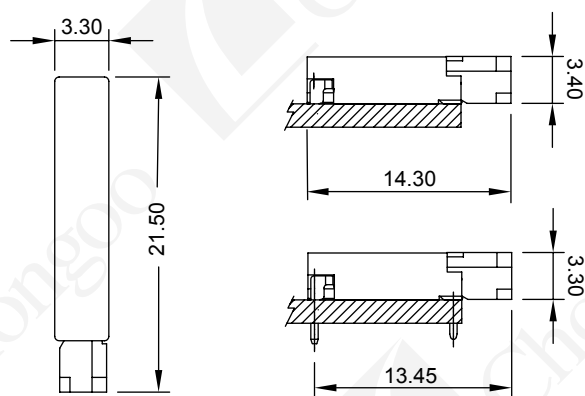

■ A3501T (Crimp Terminal)

Reference Informations:

*Used in CG A3501 Series Housing

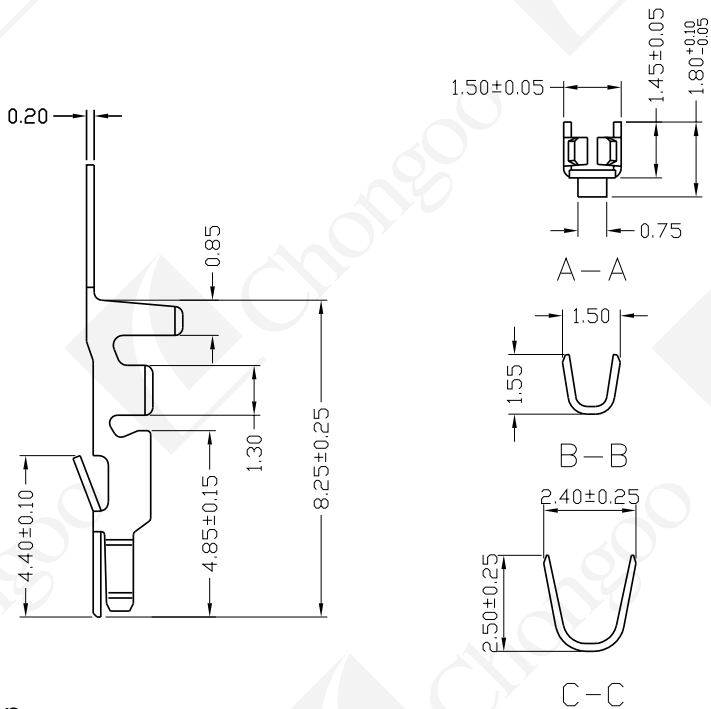
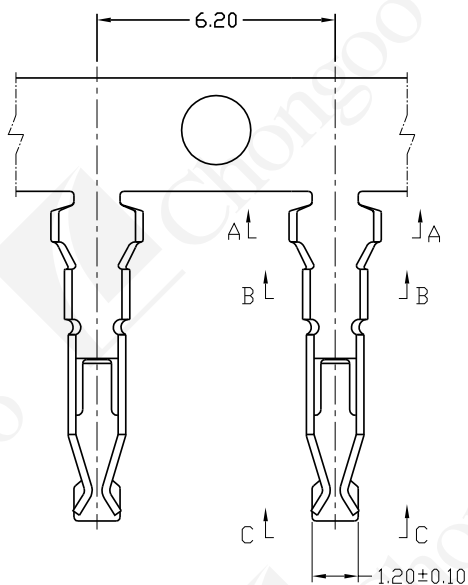

■ Ordering Information & Specification

Part No	Wire Range	Insulation O.D.	Material	Finish	Qty/Reel
A3501T-PA-Z	AWG #28~#24	1.60mm(max)	Phosphor bronze	Tin-plated	

Unit:mm



■ A3501Y-2P (Housing)

Reference Information:

- *Material: PA66 (UL94V-0)
- *Suitable CG A3501 series Terminal
- *Mates With CG A3501AW-2PS, A3502AW-2PS, A3501AWR-2PS Series Wafer and CG C3501P-2P Series Housing

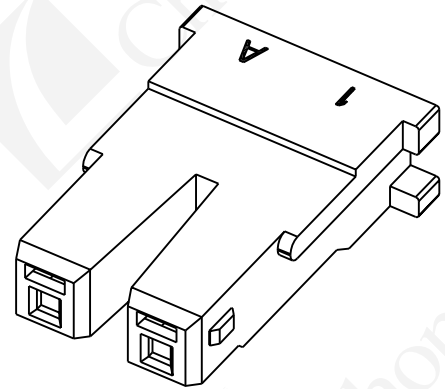
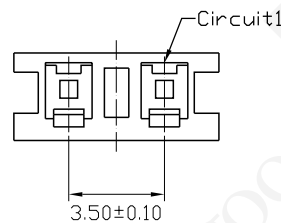
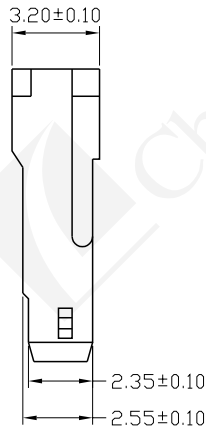
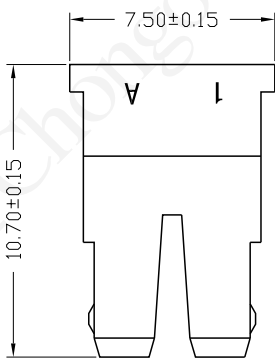

■ A3502AWR-2PS (Right Angle Wafer SMT)

Reference Information:

- *Material: Pin: Brass / Tin-plated
Solder Tabs: Brass / Tin-plated
Wafer: PA46 (UL94V-0)
- *Mates With CG A3501Y-2P Series Housing

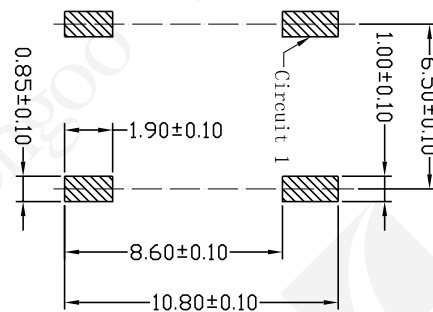
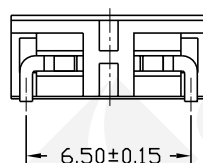
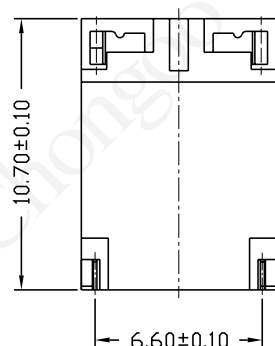
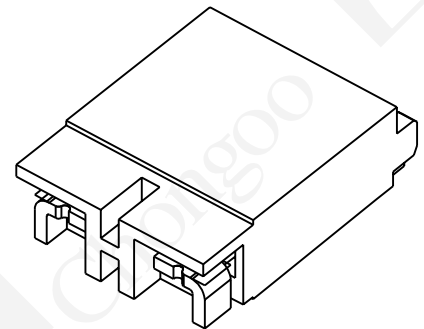
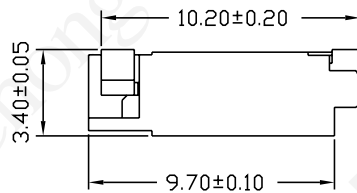
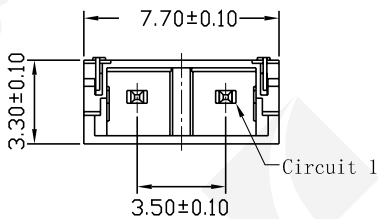

P.C.B Layout

■ A3501AW-2PS (Right Angle Wafer DIP)

Reference Informations:

*Material:Pin:Brass /Tin-plated

Solder Tabs:Brass /Tin-plated

Wafer:PA46 (UL94V-0)

*Mates With CG A3501Y-2P Series Housing

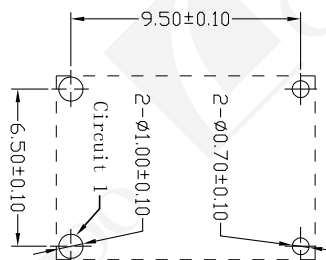
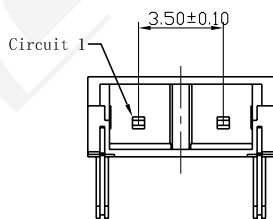
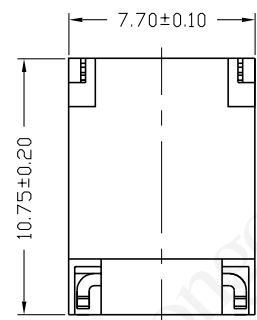
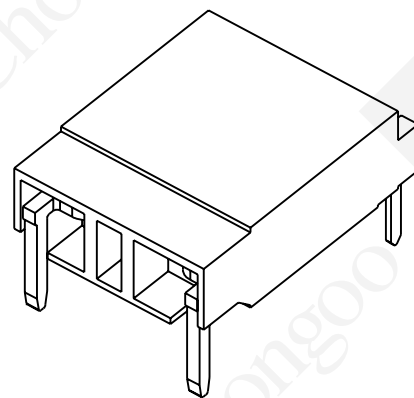
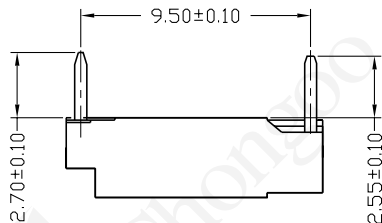
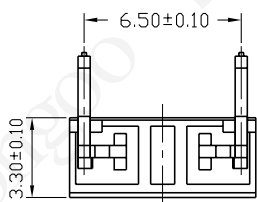

P.C.B Layout

■ C3501P-2P (Housing)

Reference Informations:

*Suitable CG A3501/C3501 series Terminal

*Material:Wafer:PA66 (UL94V-0)

*Mates With CG A3501Y-2P Series Housing

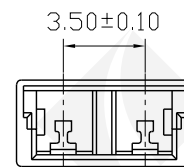
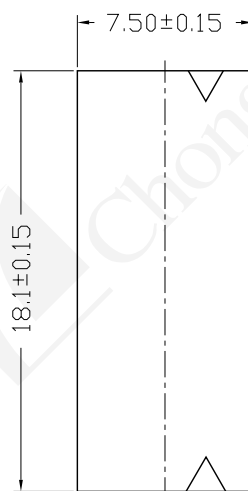
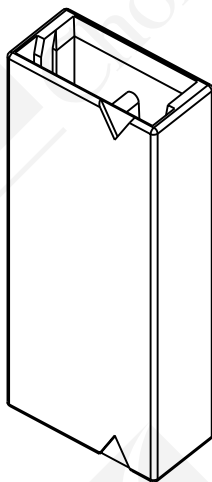

Circuit 1

Wire to Board Connector